

Transit Time Ultrasonic Flow Meters

TFX-5000 Meter

DESCRIPTION

The TFX-5000 transit time ultrasonic flow meter measures volumetric flow and heating/cooling energy rates in clean liquids as well as those with small amounts of suspended solids or aeration, such as surface water or raw sewage.

TFX-5000 flow and energy meters clamp onto the outside of pipes and do not contact the internal liquid.

BENEFITS

By clamping onto the outside of pipes, the meters have inherent advantages over other flow meter technologies, including:

- Reduced installation time and cost
- Non-invasive, non-contact measurement
- Continued operation during installation—no need to shut down the process
- No pressure head loss
- No moving parts to maintain or replace

FEATURES

- Large, bi-directional flow measuring range
- Data log up to 8 records
- Modbus® RTU or BACnet® MS/TP over EIA-485; Modbus TCP/IP; BACnet/IP; AquaCUE®/BEACON® connectivity
- Configure and troubleshoot over USB with SoloCUE
- Reynolds, ultrasonic speed and temperature compensation
- Large, easy-to-read graphical display
- Rugged, aluminum enclosure for a long service life in harsh environments

APPLICATIONS

The TFX-5000 meter is available in a variety of configurations that permit the user to select a meter with features suitable to meet particular application requirements.

The TFX-5000 meter is available in two versions:

- A flow meter for water delivery, sewage, cooling water, water-glycol mixtures, alcohols and chemicals
- A heating/cooling energy flow meter used in conjunction with dual clamp-on RTDs for temperature measurement—ideal for hydronic process and HVAC applications



OPERATION

Transit time flow meters measure the time difference between the travel time of an ultrasound wave going *with* the fluid flow and *against* the fluid flow. The time difference is used to calculate the velocity of the fluid traveling in a closed-pipe system. The transducers used in transit time measurements operate alternately as transmitters and receivers. Transit time measurements are bi-directional and are most effective for fluids that have low concentrations of suspended solids and are sonically conductive.

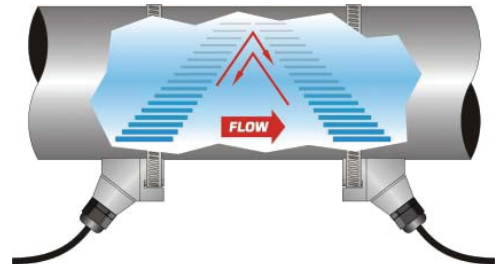

An ultrasonic meter equipped with heat flow capabilities measures the rate and quantity of heat delivered or removed from devices such as heat exchangers. By measuring the volumetric flow rate of the heat exchanger liquid, the temperature at the inlet pipe and the temperature at the outlet pipe, the energy usage can be calculated.

SPECIFICATIONS

System

Liquid Types	Most clean liquids or liquids containing small amounts of suspended solids or gas bubbles	
Flow Accuracy	Medium and Large Pipes (RZ, NZ, WZ, HZ, LZ, YZ, JZ, KZ)	$\pm 0.5\% \pm 0.049 \text{ ft/s (0.015 m/s)}$
	Small Pipes (CA-CT, UZ)	1 in. (25 mm) and larger = $\pm 1\% \pm 0.03 \text{ ft/s (0.009 m/s)}$ 3/4 in. (20 mm) and smaller = $\pm 1\%$ of full scale
Repeatability	0.2% above 1.5 ft/s	
Velocity	Medium and Large Pipes	Up to 40 ft/s, depending on pipe and fluid
	Small Pipes	Up to 20 ft/s, depending on pipe and fluid
Straight Run Requirements	10 diameters upstream, 5 diameters downstream from single elbow	
Certification and Compliance	<p>General Safety (all models): cCSAus, CE, Pollution Degree 2, CE compliance to Low Voltage Directive, 2014/35/EU</p> <p>U.S./Canada Hazardous Location transmitter and transducers: Transmitter and transducers (certification option B): cCSAus Class I Division 2 Groups ABCD T4 Requires flexible conduit Not available with UZ, HZ or JZ and KZ (Easy Rail) transducers, Auxiliary Dry Contact card or units with AquaCUE/BEACON endpoints</p> <p>Transmitter (certification option R): cCSAus Ex ec ic nC IIC T4 Gc; Ex tc IIIB T100° C Dc; Class I, Zone 2, AEx ec ic nC IIC T4 Gc; Zone 22, AEx tc IIIB T100° C Dc; Class II, Division 2, Groups FG; Class III Not available with Auxiliary Dry Contact card or units with AquaCUE/BEACON endpoints</p> <p>Transducers LZ, NZ and RZ (certification option R): cCSAus Ex ec IIC T6 Gc; Ex tc IIIB T60° C Dc; Class I, Zone 2, AEx ec IIC T6 Gc; Zone 22, AEx tc IIIB T60° C Dc; Class II, Division 2, Groups FG; Class III Requires flexible conduit Not available with CA-CT, UZ, HZ or JZ and KZ (Easy Rail) transducers</p> <p>ATEX Hazardous Location: Transmitter (certification option V): II 3 G D Ex ec ic nC IIC T4 Gc, Ex tc IIIB T100° C Dc; Tamb: -25...60° C JZ (DTTJ), KZ (DTTK), LZ (DTTL), NZ (DTTN) and RZ (DTTR) Transducers: II 3 G D Ex ec IIC T6 Gc; Ex tc IIIB T60° C Dc; Tamb: -25...60° C Not available with UZ, CA to CT, or HZ transducers; flexible conduit, Auxiliary Dry Contact card or AquaCUE/BEACON endpoints</p> <p>IECEx Hazardous Location: Transmitter (certification option V): Ex ec nC ic IIC T4 Gc; Ex tc IIIC T100° C Dc; Tamb: -25°C...60° C JZ, KZ, LZ, NZ and RZ Transducers: Ex ec IIC T6 Gc; Ex tc IIIB T60° C Dc; Tamb: -25...60° C Not available with UZ, CA to CT, or HZ transducers; flexible conduit, Auxiliary Dry Contact card or AquaCUE/BEACON endpoints</p>	

Transmitter

Power Options	24V DC/AC	9...28V DC @ 8 W max. or 20...26 AC 47...63 Hz @ 0.5 A max., 2 Amp slow-blow fuse, not field replaceable
	Mains AC	85...264V AC 47...63 Hz @ 24VA max. 1 Amp slow-blow fuse, manually field replaceable Over-Voltage Rating Category II (CAT II)
Display	Options	Display with keypad or no display/keypad
	Keypad	4-button navigation, keypad with tactile feedback; polyester film
	Display	128 × 64 pixel LED backlit graphical display; adjustable brightness and timeout; polycarbonate window
	Flow rate/total	8-digit
Enclosure	NEMA Type 4X, IP67	
Construction	Aluminum construction; painted; wall, panel or pipe mounting; stainless steel fasteners and mounting hardware; EPDM gasket	
	Conduit Holes	(4) 1/2 in. NPT, M20 × 1.5 or 1/2 BSPP; cable glands available for NPT and M20
Environmental Ratings	Pollution Degree	2
	Altitude Restriction	Up to 2000 m (6561 ft)
	Ambient Temperature Range	–4...140° F (–20...60° C)
	Storage Temperature Range	–40...176° F (–40...80° C)
	Humidity	0...85%, non-condensing
Configuration	Via optional keypad or SoloCUE configuration software; SoloCUE available on DVD or download	
Units (Field-Selectable)	Velocity	feet/second, meters/second
	Volumetric total	US Gallons, Million Gallons, Imperial Gallons, Million Imperial Gallons, Acre-Feet, Liters, Hectoliters, Cubic Meters, Cubic Feet, Oil Barrels (42 gallons), Fluid Barrels (31.5 gallons), Imperial Fluid Barrels (36 imperial gallons), Pounds (Kilograms) and custom units
	Flow rate	Acre Feet/Day, Liters/Second, Liters/Minute, Liters/Hour, Cubic Meters/Second, Cubic Meters/Minute, Cubic Meters/Hour, Cubic Feet/Minute, Cubic Feet/Minute, Cubic Feet/Hour, Gallons/Second, Gallons/Minute, Gallons/Hour, Million Gallons/Day, Imperial Gallons/Second, Imperial Gallons/Minute, Imperial Gallons/Hour, Million Imperial Gallons/Day, Oil Barrels/Day, Fluid Barrels/Day, Imperial Fluid Barrels/Day and custom units
	Energy total (energy meters)	British Thermal Unit (Btu), Thousand Btu, Millions Btu, Kilocalories, Mega calories, Kilowatt-hour, Megawatt hour, Kilojoules, Mega joules, Ton-hour (Refrigeration)
	Heat/cooling rate (energy meters)	Btu/hour, Thousand Btu/hour, Millions Btu/hour, Ton (Refrigeration), Watts, Kilowatts, Megawatts, Kilojoules/hour, Mega joules/hour, Kilocalories/hour, Mega calories/hour
	Temperature (energy meters)	Fahrenheit, Celcius, Kelvin

		Flow Meter	Energy Meter
Inputs and Outputs	0/4...20 mA output	One 16-bit, isolated, max 800 Ohms, internal or external power	Two 16-bit, isolated, max 800 Ohms, internal or external power
	Digital input	One 5...30V DC, isolated, externally or internally sourced, reset totalizer or alarm output	
	Digital output	Two selectable pulse, alarm, flow direction, sink isolated open collector, 5...30V DC, max. 50 mA externally or internally sourced, leakage current 1uA max.	Three selectable pulse, frequency, alarm, flow direction, isolated open collector, 5...30V DC, externally or internally sourced, leakage current 1uA max.
		Frequency output: 50% duty cycle, 63...10k Hz maximum frequency	
		Pulse (totalizer) output: 5 kHz max. output, open collector, pulse width 5...500 ms programmable	
		Optional: Two dry contact output for alarm or flow direction 30V DC max., 5A max. (Ethernet not available with this option)	
RTD (energy only)	None	Two 2-wire, 3-wire or 4-wire Pt100/Pt1000 RTD 12-bit inputs; Range of -40...200° C; Clamp-on resistor kits available	
Ports	Programming	USB 2.0 mini B connector for connection to a device with SoloCUE configuration software	
	EIA-485	Modbus RTU command set or BACnet MS/TP; Baud rates 9600, 14400,19200, 38400, 57600, 76800, 115k; terminating resistor selectable	
	Ethernet	Optional 10/100 Base T RJ45, communication via Modbus TCP/IP or BACnet/IP	
	AquaCUE/BEACON	Connectivity to AquaCUE/BEACON endpoint (LTE cellular)	
Data Logging	Number of points	Up to 8 parameters per record. Selectable 1 second to 1 day Transfer logs via memory card	
	Real Time Clock	Backed up with a super capacitor, minimum of 32 days of data retention without power; Requires no servicing	
	MicroSD card slot	8 GB card, included with transmitter	
Alarms	Records 150 previous alarms, warnings or errors		
Languages	English, French, German, Italian, Spanish		
Security	Four levels: Read-only, Operator, Service and Admin; 6-digit passcode number; selectable auto logout		

Transducers

Model	Construction	Cable Length Max.	Pipe/Tubing Sizes ¹	Flow Rate Max. GPM (LPM)	Pipe/Tubing Materials
CA-CT ⁵ fixed small pipe	CPVC, Ultem®, Nylon cord grip, PVC cable jacket; -40...194° F	100 ft	0.5...2 in.	190	See ²
UZ adjustable small pipe	CPVC, Ultem, and anodized aluminum track system; Nickel-plated brass connector with Teflon insulation; PVC cable jacket; -40...194° F (-40...90° C)	100 ft (30 m)	0.5...2 in. (12...50 mm)	190 (720)	
NZ (IP67) standard pipe	PVC, Ultem®, Nylon cord grip, PVC cable jacket; -40...194° F (-40...90° C)	300 ft (90 m)	2.5...12 in. (DN65...DN300)	4000 (15,000)	
RZ (IP54) standard pipe	PBT glass filled, Ultem®, Nylon cord grip; PVC cable jacket; -40...250° F (-40...121° C)	300 ft (90 m)	2.5...12 in. (DN65...DN300)	4000 (15,000)	
JZ, KZ (IP54) standard pipe, integrated rail	PBT glass filled, Ultem, Nylon cord grip; PVC cable jacket; -40...250° F (-40...121° C)	300 ft (90 m)	2.5...6 in. (DN65...DN150) 2.5...12 in. (DN65...DN300)	4000 (15,000)	
WZ (IP68) standard pipe, submersible	CPVC, Ultem, Nylon cord grip; Polyethylene cable jacket; -40...194° F (-40...90° C)	300 ft (90 m)	2.5...12 in. (DN65...DN300)	4000 (15,000)	
HZ high temperature	PTFE, Vespel, Nickel-plated brass cord grip; FEP cable jacket; -40...350° F (-40...176° C)	300 ft (90 m)	2.5...12 in. (DN65...DN300)	4000 (15,000)	
LZ (IP67) large pipe	CPVC, Ultem, Nylon cord grip PVC cable jacket; -40...194° F (-40...90° C)	300 ft (90 m)	8...48 in. (DN200...DN1200) ^{3,4}	33,000 (125,000)	
YZ (IP68) large pipe, submersible	CPVC, Ultem, Nylon cord grip; Polyethylene cable jacket; -40...194° F (-40...90° C)	300 ft (90 m)	8...48 in. (DN200...DN1200) ^{3,4}	33,000 (125,000)	

¹ Recommendations based on unlined, new pipes with water. Recommended pipe or tubing sizes vary with pipe conditions and fluid.

² PVC, CPVC, HDPE, PTFE, PDVF, stainless steel, ductile iron, aluminum, brass naval, carbon steel copper.

³ Large pipe transducers are recommended for 8...12 in. pipes if normal velocity is expected to be greater than 12 ft/s (3.6 m/s).

⁴ Consult factory for larger pipe sizes.

⁵ Not for metric pipes.

RTD Kits

Part Number	Description	Installation	RTD Type	Construction	Temperature Range
68996-001	RTD pair; 15 ft (4.5 m) cable	Pipe clamp, surface mount, IP54	Pt 1000, Class A $\pm (0.15 + 0.002^{\circ} t)$ with t as temperature °C	Aluminum body, silicone cable jacket	-58...356° F (-50...180° C)
68996-002	RTD pair; 50 ft (15 m) cable				
68996-003	RTD pair; 100 ft (30 m) cable				

SoloCUE Flow Device Manager Software

The flow meter *may* be programmed through the keypad or with SoloCUE software. If the meter is ordered without a display/keypad, the flow meter *must* be programmed with SoloCUE software. The software is used to configure, calibrate and communicate with TFX-5000 meters with English, French, German, Italian and Spanish menus. Additionally, it has numerous troubleshooting tools to make diagnosing and correcting installation problems easier.

SoloCUE	Used to configure, calibrate and troubleshoot flow meters and control valves; Software is compatible with Windows 7, 8, 10
USB Cable	RC820648 USB 2.0 mini B connector to A connector, shielded

DIMENSIONS

Remote System Enclosure

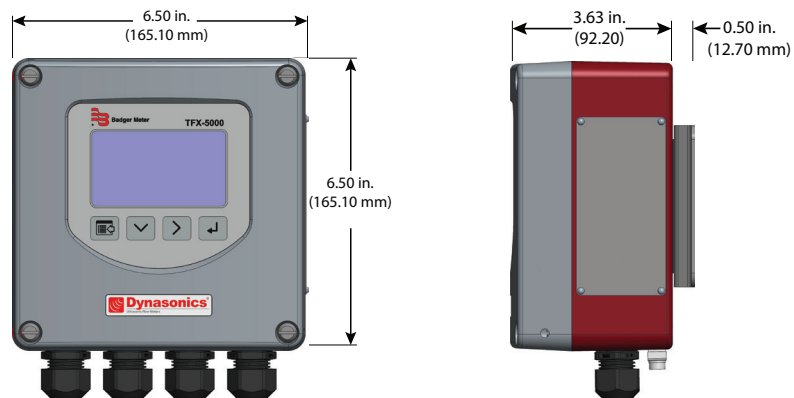

Panel Mount Enclosure

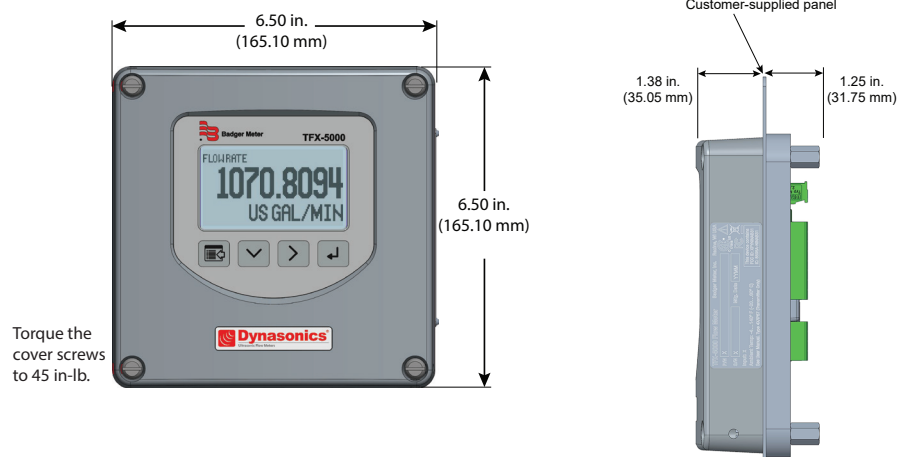

Consult factory for part number selection.

Transducers

Fixed Small Pipe

Pipes and Tubing 1/2...2 in. (Not for metric pipes.)

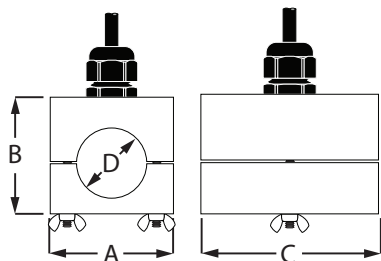

Fixed Small Pipe U-Bolt Connections CF, CL

ANSI/DN and Copper 2 in. Models (Not for metric pipes.)

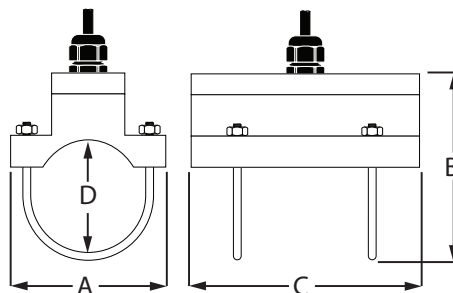

RZ

Pipes Larger than 2 in. (50 mm)

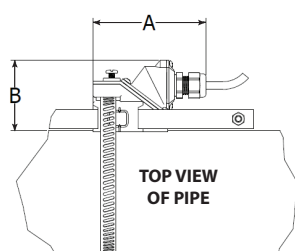

NZ, WZ, HZ, LZ, YZ

Pipes Larger than 2 in. (50 mm)

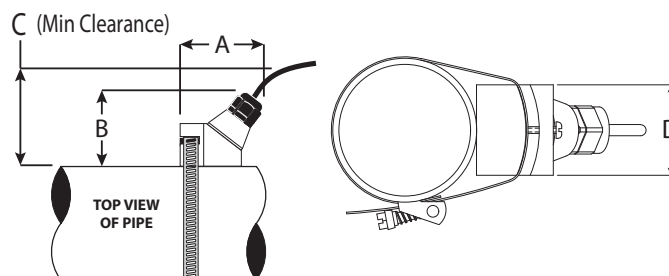

UZ

Adjustable Small Pipe

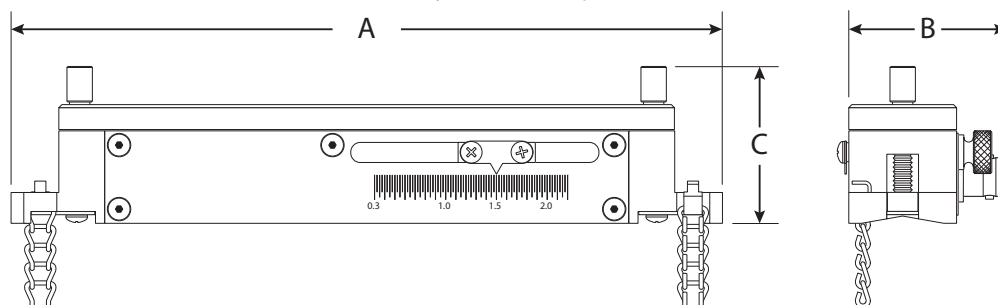

Easy Rail (JZ, KZ)

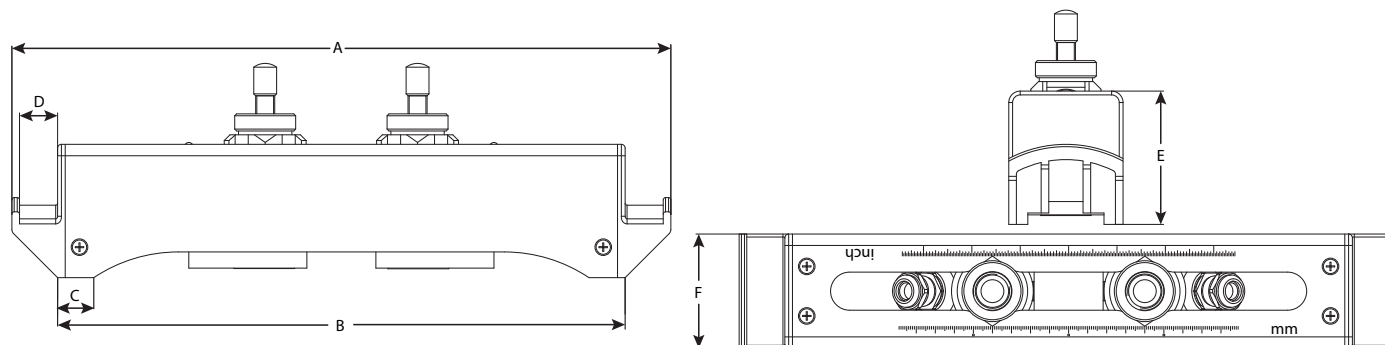

	RZ	NZ, WZ	HZ	LZ, YZ	UZ	JZ	KZ
A	3.75 in. (95 mm)	2.95 in. (74.9 mm)	2.95 in. (74.9 mm)	3.40 in. (86.4 mm)	7 in. (178 mm)	13.62 in. (345.95 mm)	19.92 in. (505.97 mm)
B	2.35 in. (60 mm)	2.75 in. (69.8 mm)	2.75 in. (69.8 mm)	2.94 in. (74.7 mm)	1.6 in. (42 mm)	11.73 in. (297.94 mm)	18.03 in. (457.96 mm)
C	—	3.00 in. (76.2 mm)	3.00 in. (76.2 mm)	3.20 in. (81.3 mm)	1.5 in. (39 mm)	0.75 in. (19.05 mm)	0.75 in. (19.05 mm)
D	2.19 in. (56 mm)	1.70 in. (43.2 mm)	1.71 in. (43.4 mm)	2.50 in. (63.5 mm)	—	0.79 in. (20.06 mm)	0.79 in. (20.06 mm)
E	—	—	—	—	—	2.76 in. (70.10 mm)	2.76 in. (70.10 mm)
F	—	—	—	—	—	2.36 in. (59.94 mm)	2.36 in. (59.94 mm)

PART NUMBER CONSTRUCTION

Part Number Construction for TFX-5000 Flow Meters for Pipes 2 in. and Smaller

	DQ	-	G	-		-		-		-		-		-	XX	-		-		-	
Model																					
TFX-5000 Ultrasonic Clamp-On Meter		DQ																			
Certification																					
General Area US/Canada, CE		G																			
Transducer Type¹																					
1/2 inch ANSI Pipe		CA																			
3/4 inch ANSI Pipe		CB																			
1 inch ANSI Pipe		CC																			
1-1/4 inch ANSI Pipe		CD																			
1-1/2 inch ANSI Pipe		CE																			
2 inch ANSI Pipe		CF																			
1/2 inch Copper Tube		CG																			
3/4 inch Copper Tube		CH																			
1 inch Copper Tube		CT																			
1-1/4 inch Copper Tube		CJ																			
1-1/2 inch Copper Tube		CK																			
2 inch Copper Tube		CL																			
Small pipe, universal, DTTSU (not available with conduit)		UZ																			
Transmitter Type																					
110/220V AC Remote Mounted		R																			
24V DC/AC Remote Mounted		B																			
Display																					
Display and Keypad		S																			
No Display/Keypad		W																			
Remote Cable Length																					
15 feet (4.5 m)		AC																			
30 feet (9 m)		AF																			
50 feet (15 m)		AK																			
75 feet (23 m)		AR																			
100 feet (30 m)		BW																			
Conduit Type and Length (Conduit length is less than or equal to cable length)																					
None		WW																			
5 feet (1.5 m)		AA																			
15 feet (4.5 m)		AC																			
30 feet (9 m)		AF																			
50 feet (15 m)		AK																			
75 feet (23 m)		AR																			
100 feet (30 m)		BW																			
Hardware																					
1/2 in. NPT Threads, Poly cable glands		S																			
1/2 in. NPT Threads, Nickel Plated Brass cable glands		T																			
1/2 in. NPT Threads, no cable glands		N																			
M20 Threads, Poly cable glands		C																			
M20 Threads, Nickel Plated Brass cable glands		D																			
M20 Threads, no cable glands		A																			
Endpoint Wiring Method																					
None		XX																			
Communication/Output																					
Standard Output (Modbus RTU or BACnet MS/TP field selectable)		S																			
Standard Output plus Modbus TCP Ethernet		T																			
Standard Output plus BACnet/IP Ethernet		V																			
Standard Output plus Aux Output		9																			
Units of Measure Totalizer/Flow Rate																					
Gallons/gallons per minute (field selectable, additional options available)		G																			
Testing & Tagging																					
Factory Calibrated		F																			
Factory Calibrated/Stainless Steel Tag		S																			

¹Stainless steel tube 1/2...2 in. options are available.

Part Number Construction for TFX-5000 Flow Meters for Pipes 2 in. and Smaller for Hazardous Locations

	DQ	B								XX			
Model													
TFX-5000 Ultrasonic Clamp-On Meter													
Certification													
Hazardous Location, Class I, Division 2													
Transducer Type ¹													
1/2 inch ANSI Pipe	CA												
3/4 inch ANSI Pipe	CB												
1 inch ANSI Pipe	CC												
1-1/4 inch ANSI Pipe	CD												
1-1/2 inch ANSI Pipe	CE												
2 inch ANSI Pipe	CF												
1/2 inch Copper Tube	CG												
3/4 inch Copper Tube	CH												
1 inch Copper Tube	CT												
1-1/4 inch Copper Tube	CJ												
1-1/2 inch Copper Tube	CK												
2 inch Copper Tube	CL												
Transmitter Type													
110/220V AC Remote Mounted	R												
24V DC/AC Remote Mounted	B												
Display													
Display and Keypad	S												
No Display/Keypad	W												
Remote Cable/Conduit Length ²													
15 feet (4.5 m)	AC	AC											
30 feet (9 m)	AF	AF											
50 feet (15 m)	AK	AK											
75 feet (23 m)	AR	AR											
100 feet (30 m)	BW	BW											
Hardware													
1/2 in. NPT Threads, Poly cable glands	S												
1/2 in. NPT Threads, Nickel Plated Brass cable glands	T												
1/2 in. NPT Threads, no cable glands	N												
M20 Threads, Poly cable glands	C												
M20 Threads, Nickel Plated Brass cable glands	D												
M20 Threads, no cable glands	A												
Endpoint Wiring Method													
None	XX												
Communication/Output													
Standard Output (Modbus RTU or BACnet MS/TP field selectable)	S												
Standard Output plus Modbus TCP Ethernet	T												
Standard Output plus BACnet/IP Ethernet	V												
Units of Measure Totalizer/Flow Rate													
Gallons/gallons per minute (field selectable, additional options available)	G												
Testing & Tagging													
Factory Calibrated	F												
Factory Calibrated/Stainless Steel Tag	S												

¹Stainless steel tube 1/2...2 in. options are available.² For hazardous location units, Remote Cable and Conduit Length codes must match.

Part Number Construction for TFX-5000 Flow Meters for Pipes Larger than 2 in.

	DQ	-	G	-		-		-		-		-		-	XX	-		-		-	
Model																					
TFX-5000 Ultrasonic Clamp-On Meter																					
Certification																					
General Area US/Canada, CE																					
Transducer Type																					
Medium pipe, DTTR, 2.5 in. (65 mm) or larger																					
Medium pipe, submersible DTTN, 2.5 in. (65 mm) or larger ¹																					
2.5...6 inches (65...150 mm) Easy Rail (not available with conduit)																					
2.5...12 inches (65...300 mm) Easy Rail (not available with conduit)																					
Medium pipe, high temperature (not available with conduit)																					
Large pipe, DTTL, 8 in. (200 mm) or larger																					
Large pipe, submersible DTTL, 8 in. (200 mm) or larger ¹																					
Transmitter Type																					
110/220V AC Remote Mounted																					
24V DC/AC Remote Mounted																					
Display																					
Display and Keypad																					
No Display/Keypad																					
Remote Cable Length																					
15 feet (4.5 m)																					
30 feet (9 m)																					
50 feet (15 m)																					
75 feet (23 m)																					
100 feet (30 m)																					
150 feet (46 m)																					
200 feet (61 m)																					
250 feet (76 m)																					
300 feet (90 m)																					
350 feet (107 m) (DTTL "LZ" and "YZ" only)																					
400 feet (122 m) (DTTL "LZ" and "YZ" only)																					
450 feet (137) (DTTL "LZ" and "YZ" only)																					
500 feet (152 m) (DTTL "LZ" and "YZ" only)																					
550 feet (168) (DTTL "LZ" and "YZ" only)																					
600 feet (183 m) (DTTL "LZ" and "YZ" only)																					
Conduit Type and Length (Conduit length is less than or equal to cable length)																					
None																					
5 feet (1.5 m)																					
15 feet (4.5 m)																					
30 feet (9 m)																					
50 feet (15 m)																					
75 feet (23 m)																					
100 feet (30 m)																					
150 feet (46 m)																					
200 feet (61 m)																					
250 feet (76 m)																					
300 feet (90 m)																					
Hardware																					
1/2 in. NPT Threads, Poly cable glands																					
1/2 in. NPT Threads, Nickel Plated Brass cable glands																					
1/2 in. NPT Threads, no cable glands																					
M20 Threads, Poly cable glands																					
M20 Threads, Nickel Plated Brass cable glands																					
M20 Threads, no cable glands																					
Endpoint Wiring Method																					
None																					
Communication/Output																					
Standard Output (Modbus RTU or BACnet MS/TP field selectable)																					
Standard Output plus Modbus TCP Ethernet																					
Standard Output plus BACnet/IP Ethernet																					
Standard Output plus Aux Output																					
Units of Measure Totalizer/Flow Rate																					
Gallons/gallons per minute (field selectable, additional options available)																					
Testing & Tagging																					
Factory Calibrated																					
Factory Calibrated/Stainless Steel Tag																					

¹ Submersible transducer cables use two conduit openings.

Part Number Construction for TFX-5000 Flow Meters for Pipes Larger than 2 in. for Hazardous Locations

<div> <div>DQ</div> <div>-</div> <div></div> <div>-</div> <div></div> <div>-</div> <div></div> <div>-</div> <div></div> <div>-</div> <div></div> <div>-</div> <div></div> <div>-</div> <div>XX</div> <div>-</div> <div></div> <div>-</div> <div></div> <div></div> </div>												
Model												
TFX-5000 Ultrasonic Clamp-On Meter				DQ								
Certification												
Hazardous Location, Class I, Division 2				B								
Hazardous Location Class I, Zone 2/Zone 22; Class II/III				R								
Transducer Type												
Medium pipe, DTTR, 2.5 in. (65 mm) or larger				RZ								
Medium pipe, submersible DTTN, 2.5 in. (65 mm) or larger ¹				WZ								
Large pipe, DTTL, 8 in. (200 mm) or larger				LZ								
Large pipe, submersible DTTL, 8 in. (200 mm) or larger ¹				YZ								
Transmitter Type												
110/220V AC Remote Mounted				R								
24V DC/AC Remote Mounted				B								
Display												
Standard				S								
No Display/Keypad				W								
Remote Cable/Conduit Length												
15 feet (4.5 m)							AC	AC				
30 feet (9 m)							AF	AF				
50 feet (15 m)							AK	AK				
75 feet (23 m)							AR	AR				
100 feet (30 m)							BW	BW				
150 feet (46 m)							BK	BK				
200 feet (61 m)							DW	DW				
250 feet (76 m)							DK	DK				
300 feet (90 m)							EW	EW				
Hardware												
1/2 in. NPT Threads, Poly cable glands								S				
1/2 in. NPT Threads, Nickel Plated Brass cable glands								T				
1/2 in. NPT Threads, no cable glands								N				
M20 Threads, Poly cable glands								C				
M20 Threads, Nickel Plated Brass cable glands								D				
M20 Threads, no cable glands								A				
Endpoint Wiring Method												
None								XX				
Communication/Output												
Standard Output (Modbus RTU or BACnet MS/TP field selectable)									S			
Standard Output plus Modbus TCP Ethernet									T			
Standard Output plus BACnet/IP Ethernet									V			
Units of Measure Totalizer/Flow Rate												
Gallons/gallons per minute (field selectable, additional options available)										G		
Testing & Tagging												
Factory Calibrated											F	
Factory Calibrated/Stainless Steel Tag											S	

¹ Submersible transducer cables use two conduit openings.

Part Number Construction for TFX-5000 Flow Meters for Pipes Larger than 2 in. for ATEX/IECEx Hazardous Locations

DQ	-		-		-		-		-		-		-	XX	-		-		-	
----	---	--	---	--	---	--	---	--	---	--	---	--	---	----	---	--	---	--	---	--

Model

TFX-5000 Ultrasonic Clamp-On Meter

DQ

Certification

Hazardous Location, ATEX, IECEx

V

Transducer Type

Medium pipe, DTTR, 2.5 in. (65 mm) or larger

RZ

Medium pipe, submersible DTTN, 2.5 in. (65 mm) or larger ¹

WZ

2.5...6 inches (65...150 mm) Easy Rail (not available with conduit)

JZ

2.5...12 inches (65...300 mm) Easy Rail (not available with conduit)

KZ

Large pipe, DTTL, 8 in. (200 mm) or larger

LZ

Large pipe, submersible DTTL, 8 in. (200 mm) or larger ¹

YZ

Transmitter Type

110/220V AC Remote Mounted

R

24V DC/AC Remote Mounted

B

Display

Display and Keypad

S

No Display/Keypad

W

Remote Cable Length

15 feet (4.5 m)

AC

30 feet (9 m)

AF

50 feet (15 m)

AK

75 feet (23 m)

AR

100 feet (30 m)

BW

150 feet (46 m)

BK

200 feet (61 m)

DW

250 feet (76 m)

DK

Conduit Type and Length (Conduit length is less than or equal to cable length)

None

WW

Hardware

1/2 in. NPT Threads, Poly cable glands

S

1/2 in. NPT Threads, Nickel Plated Brass cable glands

T

1/2 in. NPT Threads, no cable glands

N

M20 Threads, Poly cable glands

C

M20 Threads, Nickel Plated Brass cable glands

D

M20 Threads, no cable glands

A

Endpoint Wiring Method

None

XX

Communication/Output

Standard Output (Modbus RTU or BACnet MS/TP field selectable)

S

Standard Output plus Modbus TCP Ethernet

T

Standard Output plus BACnet/IP Ethernet

V

Units of Measure Totalizer/Flow Rate

Gallons/gallons per minute (field selectable, additional options available)

G

Testing & Tagging

Factory Calibrated

F

Factory Calibrated/Stainless Steel Tag

S

¹ Submersible transducer cables use two conduit openings.

NOTE: Check for availability.

Part Number Construction for TFX-5000 Energy Meters for Pipes 2 in. and Smaller

		DR	-	G	-		-		-		-		-		-		-	XX	-		-		-	
Model																								
TFX-5000 Ultrasonic Clamp-On Meter		DR																						
Certification																								
General Area US/Canada, CE		G																						
Transducer Type¹																								
1/2 inch ANSI Pipe		CA																						
3/4 inch ANSI Pipe		CB																						
1 inch ANSI Pipe		CC																						
1-1/4 inch ANSI Pipe		CD																						
1-1/2 inch ANSI Pipe		CE																						
2 inch ANSI Pipe		CF																						
1/2 inch Copper Tube		CG																						
3/4 inch Copper Tube		CH																						
1 inch Copper Tube		CT																						
1-1/4 inch Copper Tube		CJ																						
1-1/2 inch Copper Tube		CK																						
2 inch Copper Tube		CL																						
Small pipe, universal, DTTSU (not available with conduit)		UZ																						
Transmitter Type																								
110/220V AC Remote Mounted		R																						
24V DC/AC Remote Mounted		B																						
Display																								
Display and Keypad		S																						
No Display/Keypad		W																						
Remote Cable Length																								
15 feet (4.5 m)		AC																						
30 feet (9 m)		AF																						
50 feet (15 m)		AK																						
75 feet (23 m)		AR																						
100 feet (30 m)		BW																						
Conduit Type and Length (Conduit length is less than or equal to cable length)																								
None		WW																						
5 feet (1.5 m)		AA																						
15 feet (4.5 m)		AC																						
30 feet (9 m)		AF																						
50 feet (15 m)		AK																						
75 feet (23 m)		AR																						
100 feet (30 m)		BW																						
RTD Type																								
Surface, Commercial		C																						
None (user provided)		X																						
RTD Length																								
15 feet		AC																						
50 feet		AK																						
100 feet		BW																						
None (user provided)		WW																						
Hardware																								
1/2 in. NPT Threads, Poly cable glands		S																						
1/2 in. NPT Threads, Nickel Plated Brass cable glands		T																						
1/2 in. NPT Threads, no cable glands		N																						
Endpoint Wiring Method																								
None		XX																						
Communication/Output																								
Standard Output (Modbus RTU or BACnet MS/TP field selectable)		S																						
Standard Output plus Modbus TCP Ethernet		T																						
Standard Output plus BACnet/IP Ethernet		V																						
Standard Output plus Auxiliary Dry Contact Output		9																						
Units of Measure Totalizer/Flow Rate																								
Gallons/gallons per minute (field selectable, additional options available)		G																						
Units of Measure Energy Totalizer/Rate																								
Kilowatt-hour/Watt (field selectable, additional options available)		R																						
Testing & Tagging																								
Factory Calibrated		F																						
Factory Calibrated/Stainless Steel Tag		S																						

¹ Stainless steel tube 1/2...2 in. options are available.

Part Number Construction for TFX-5000 Energy Meters for Pipes Larger than 2 in.

[illegible]

¹ Submersible transducer cables use two conduit openings.

INTENTIONAL BLANK PAGE

INTENTIONAL BLANK PAGE

Control. Manage. Optimize.

Dynasonics, AquaCUE and SoloCUE are registered trademarks of Badger Meter, Inc. Other trademarks appearing in this document are the property of their respective entities. Due to continuous research, product improvements and enhancements, Badger Meter reserves the right to change product or system specifications without notice, except to the extent an outstanding contractual obligation exists. © 2020 Badger Meter, Inc. All rights reserved.

www.badgermeter.com